

MLC
ML
MLG

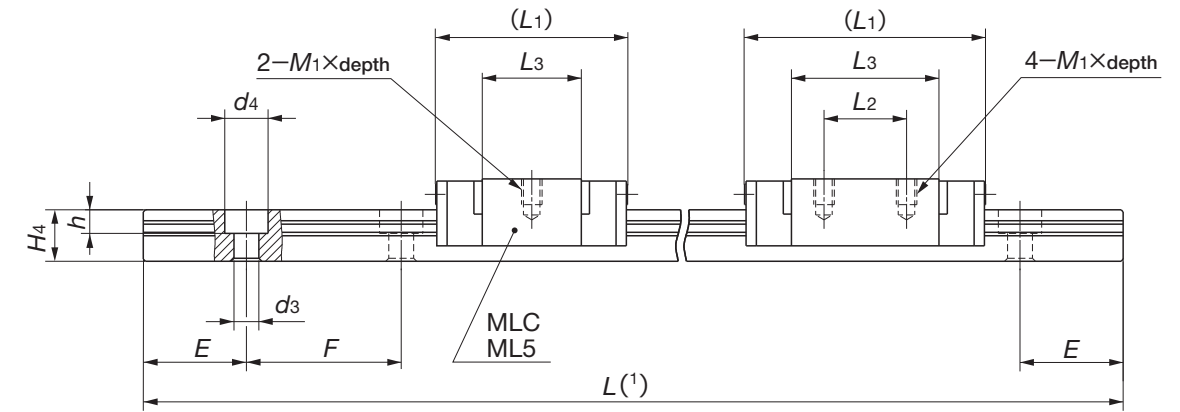
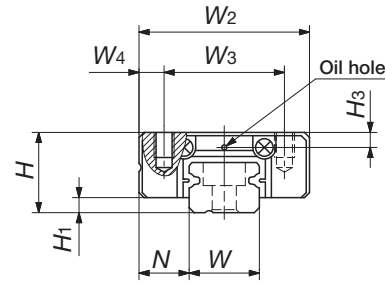

Model number	Interchangeable	Mass (Reference) g		Dimension of assembly mm			Dimension of slide unit mm							
		Slide unit	Track rail (per 100mm)	H	H ₁	N	W ₂	W ₃	W ₄	L ₁	L ₂	L ₃	M ₁ × depth	
MLC 5	☆	3.4	12	6	1	3.5	12	8	2	16	-	9.6	M2 × 1.5	
ML 5	☆	4.3								19		12.6		
MLC 7	☆	6.7	22	8	1.5	5	17	12	2.5	19	-	9.6	M2 × 2.5	
ML 7	☆	9.1								23.5		8		14.3
MLG 7	☆	13								31		12		21.6
MLC 9	☆	11	35	10	2	5.5	20	15	2.5	21.5	-	11.9	M3 × 3	
ML 9	☆	18								30		10		20.8
MLG 9	☆	26								40.5		15		30.9
MLC 12	☆	22	65	13	3	7.5	27	20	3.5	25	-	13	M3 × 3.5	
ML 12	☆	34								34		15		21.6
MLG 12	☆	48								44		20		32

H ₃	Dimension of track rail mm								Appended mounting bolt for track rail mm Bolt size x length	Basic dynamic load rating ⁽²⁾ C N	Basic static load rating ⁽²⁾ C ₀ N	Static moment rating ⁽²⁾		
	W	H ₄	d ₃	d ₄	h	E	F	T ₀ N·m				T _x N·m	T _y N·m	
1.2	5	3.7	2.4	3.6	0.8	7.5	15	Cross-recessed head cap screw for precision equipment M2×6	562	841	2.2	1.4	1.2	
									676	1 090	2.9	8.5	7.2	
1.5	7	5	2.4	4.2	2.3	7.5	15	Hexagon socket head bolt M2×6	937	1 140	4.1	1.8	1.5	
									1 330	1 890	6.9	14.9	12.5	
									1 690	2 650	9.7	4.7	3.9	
2.2	9	6	3.5	6	3.5	10	20	Hexagon socket head bolt M3×8	1 180	1 480	6.9	2.9	2.4	
									1 810	2 760	12.8	21.4	18.0	
									2 370	4 030	18.7	9.1	7.6	
2.7	12	8	3.5	6.5	4.5	12.5	25	Hexagon socket head bolt M3×8	2 210	2 380	14.8	5.3	4.5	
									3 330	4 290	26.6	41.7	35.0	
									4 310	6 200	38.4	15.4	12.9	
												30.6	25.7	
												168	141	

Note⁽¹⁾ : Track rail lengths L are shown in Table 8.1 on page A-8.
⁽²⁾ : The directions of basic dynamic load rating (C), basic static load rating (C₀) and static moment rating (T₀, T_x and T_y) are shown in the sketches below. The upper values in the T_x and T_y column apply to one slide unit, and the lower values apply to two units in close contact.
Remark 1 : The mark ☆ indicates that it is also applicable to interchangeable specification.
2 : The appended bolts for mounting track rails are stainless hexagon socket head bolts of JIS B1176 or equivalent, or stainless cross-recessed head cap screws for precision equipment.
3 : Oil hole is provided for ML5 to ML12 models.
4 : For specification of oil hole, see page 99.

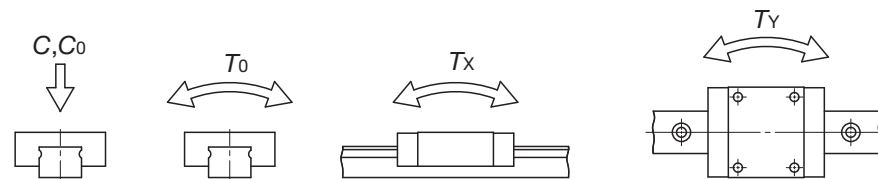

Example of identification number for assembled set (For details, see "Identification number and specification".)

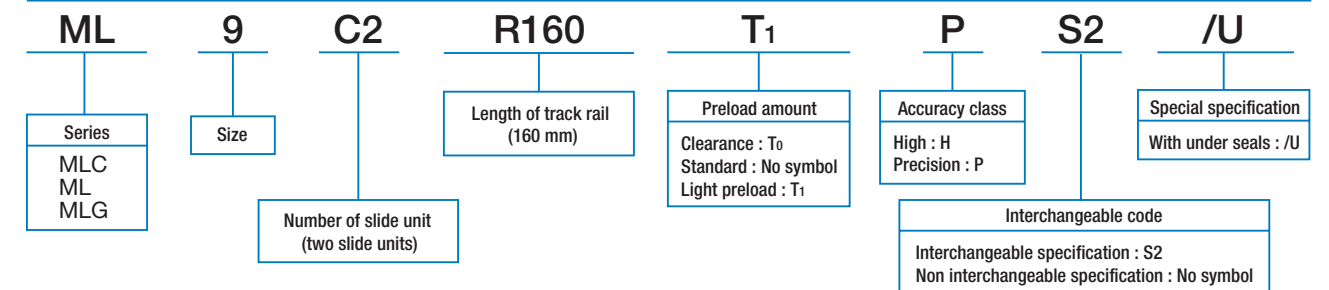

※In case ordering track rail only, model code is changed as shown below.
 Track rail of interchangeable ML → Model code LWL...B (Ex: LWL9R160BPS2)